

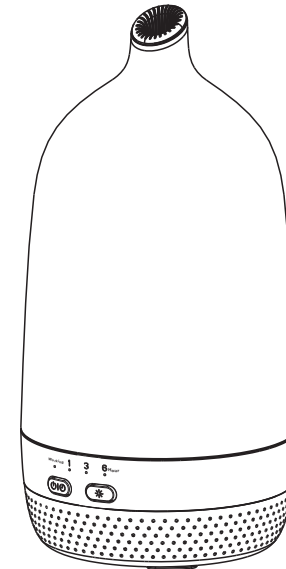

HOME SPA

Aroma diffuser



For home use only

Thank You for purchasing Home Spa Aroma Diffuser.

CONTENTS

1. Introduction
2. Safety Instructions
3. Specification
4. Appliance description
5. Filling of tank with water
6. Appliance operation
7. Cleaning and maintenance
8. Trouble shooting
9. Transportation and Storage
10. Disposal

1. INTRODUCTION

Home Spa Aroma Diffuser & Humidifier is ideal to be used in Living Rooms. It neutralizes the dryness & helps in humidification & removal of unpleasant odors, pollutants & other harmful substances from the interiors. When used with essential oils it adds to the charm of your living space & improves the quality of air surrounding you and your loved ones. It relieves stress & soothes mind.

2. SAFETY INSTRUCTIONS

Please, read the instruction manual carefully prior using the product. While using the appliance, it is necessary to observe some precautions. Improper operation may result in personal injury to the user or other people, as well as damage to property. Aroma diffuser is designed to work in habitable rooms with observation of the stated operating conditions. Using of the diffuser not for its intended purpose may create situations dangerous to life and health. The electric appliance, while in operation, should be under supervision, especially if it is used in a room with children. The appliance is not intended for use by persons (including children) with physical, sensory or mental disabilities, or having insufficient experience and knowledge, if they are not under supervision and have not received instructions for use of the appliance from a person responsible for their safety. Please, make sure that children do not play with the appliance. Use the appliance only in accordance with the user manual. Never use the diffuser with a damaged power cord or plug and if the diffuser is broken or

damaged by falling or in other circumstances.

It should be operated only in the fully assembled condition. To avoid a burn, do not touch the membrane of the operating diffuser. High frequency of oscillations results in heating of the membrane.

NOTE:

High-frequency oscillations of the ultrasonic diffuser membrane are noiseless and safe for people and pets.

To avoid electric shock, the damaged power cord should be replaced only in authorized service centers by qualified specialists.

To avoid the electric shock, do not place the power cord near heating appliances and inflammable or combustible materials.

To avoid traumas and property damage, do not try to repair the diffuser by yourself.

Unplug the diffuser in the following cases: before discharge or filling of a tank with water; before cleaning and maintenance; before assembling/disassembling of elements; before displacement of the diffuser. Install the diffuser on flat dry surface. Outgoing steam may damage exposed surfaces.

Do not install the diffuser on the floor, as well as in close proximity to heating appliances, walls, furniture and other objects.

The manufacturer and vendor are not responsible for damages caused by incorrect position of the diffuser.

Diffuser should be installed on a rise – e.g. on a table, pedestal, etc.

Never fill the water in the humidifier through a diffuser.

Do not immerse the unit in water or other liquids.

Do not install the unit in a passage or in other places, where it can be touched, overturned, etc.

If the unit is not in use, unplug it.

Do not lay a power cable under a carpet or other objects. While placing the device, be careful that you do not touch the power cable by accident.

Do not use the unit in damp rooms.

Prevent the ingress of foreign objects into the device.

Do not block an air intake and the diffuser with foreign objects.

Do not sit or stand on the device and do not put heavy objects on it.

3. SPECIFICATION

Table 1

Product Name	Aroma diffuser
Voltage	220v~
Power	9 W
Capacity of water tank	200ml
Mist	15-25ml/h

4. APPLIANCE DESCRIPTION

1. Mist out-let
2. Shell
3. Mist out-let silicon
4. Water tank cover
5. Max scale of water tank
6. Water tank
7. Base
8. Button
9. Metal base
10. Silicon feet

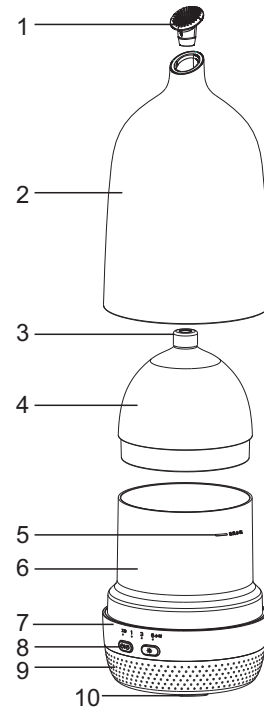

5. FILLING TANK WITH WATER

Always unplug the unit before removing the water tank. Do not touch the water in the base during operation.

1. Remove the Outer shell and body cover

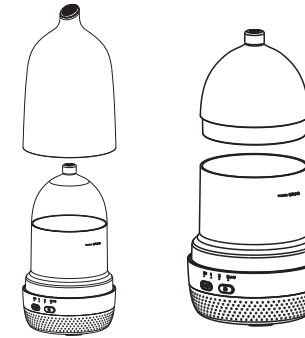

2. Fill the water tank with clean, cold or purified water. Water temperature should be around 6°C to 40°C. Do not pour water above the MAX scale level of the tank.

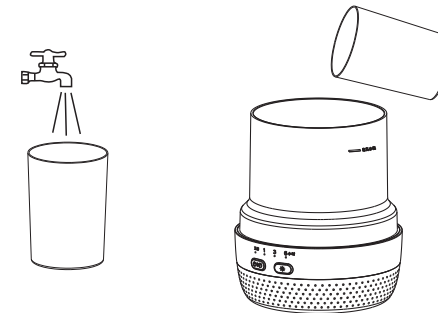

3. Pour the aroma oil inside in moderate amounts. (Preferably 2-3 drops)



4. Do not pour water into the mist outlet of the appliance.
5. Cover the water tank and shell.
6. Insert the plug into the socket, a buzzer alarm rings which indicates the appliance is connected.
7. Switch on the appliance using the on/off button, aroma indicator light can be turned on or off as per requirement.
8. Indicator light color changes to red when water tank has less water.
9. Do not move the appliance before turning off. Do not move the appliance during working.
10. If the appliance stops working due to lack of water, turn off , unplug and refill the water tank.

6. APPLIANCE OPERATION

1. On/off & Timer

Connect to power; a buzzer alarm indicates the appliance is connected to power. Press the on/off button; appliance starts to produce the mist by default. Press the on/off & timer button again, timer sets to 1 hour as default. Press 3rd time, timer sets to 3 hours, 4th time to set 6 hours, 5th press to switch off the appliance.

2. Aroma indicator light

Product has 3 different indicator lights . Change the light by pressing the Indicator light button.

- 1st press -- orange-red color,
- 2nd press – pink color,
- 3rd press –light blue color,
- 4th press – indicator light off.

3. Water shortage status

Indicator light turns red when there is insufficient water in the tank.

7. CLEANING AND MAINTENANCE

- Always unplug the unit before removing the water tank.

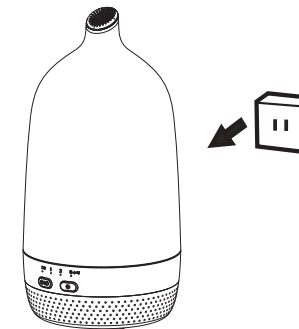

- Do not touch the water in the base during operation!
- Caution-risk of electric shock and damage to the product!
- Switch off the appliance and unplug it from the socket before cleaning it.
- Clean the water tank and the base regularly. Use water only, no detergents.



IMPORTANT!

To avoid deformation or wear & tear of working surfaces, resulting in decreased atomizing or other malfunctions, do not use metallic brushes, blades or talc powder to wipe the atomizer's surface. The water tank may leak upon heavy impacts. In case of water leakage, immediately stop using the unit and contact a service center. To keep the unit dry, remove water after cleaning and make sure to dry the unit's case. Make sure that there is no water left inside the unit's case. Prior to a long break in using the unit, dry its surface and pack it in a plastic bag, then put it in a box. Store the unit in a low-humidity room. Storing the unit undried results in generation of mold.

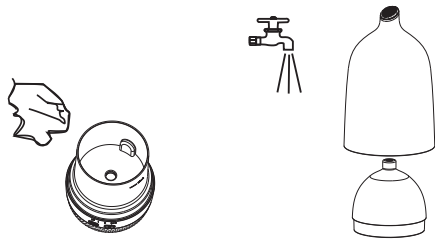

8. TROUBLESHOOTING

In case of emergency, please, use the troubleshooting methods shown in tables. If it is impossible to solve problem with these methods, contact our customer care.

Problem	Possible cause	Remedy
Poor atomizing (insufficient capacity)	The unit is operating in the minimized mode (low atomizing frequency)	There is no problem. If you need to switch to the intense mode of operation, turn the regulator handle all the way to the right.
	The atomizer is clogged	Clean the atomizer.
	Temperature of water in the tank is too low	Set maximum capacity. The diffuser's capacity will go up after a while.
No atomizing	The power cord is poorly connected to the outlet	Connect the power cord into the outlet carefully
There is white deposit on objects around the diffuser (salts, separating out from water)	1. Lime deposits have formed on the membrane 2. There are lot of salts in the water used (calcium and magnesium)	1. Clean the diffuser's membrane with a special brush 2. Use filtered water
Steam has an unpleasant odor	Stale water is used	Clean the unit according to the cleaning and servicing instructions and fill the tank with fresh & pure water
	Remains of stale water or waste have accumulated in the unit's case or the atomizer	
Condensate is formed on the upper part of the diffuser and on surrounding objects, when it is operating.	1. High humidification intensity is set. 2. High room humidity and temperature.	Lower the humidification intensity by turning the on/off and steam outflow intensity regulator counterclockwise.
Water appears next to the diffuser, when it is operating.	1. High humidification intensity is set. 2. Lime deposits have formed on the membrane and in grooves for water (in the unit's base).	1. Lower the humidification intensity by turning the on/off and steam outflow intensity regulator counterclockwise. 2. Clean the unit according to the cleaning and servicing instructions.

Water appears/accumulates next to the diffuser	Water tank is leaking	You need to contact an authorized service center
when it is not operating		

9. TRANSPORTATION AND STORAGE

- When transporting, any possible impacts and movements of the package inside a vehicle must be avoided.
- Handling symbols on the unit's package must be strictly observed when transporting and storing it.

3. Temperature requirements*	Transportation and storage	-30°C to +50°C
Humidity requirements*		15% to 85% (no condensate)

We are researching new technologies and constantly improving the quality of our products.

Specifications, design and scope of delivery may be changed without any prior notice.

- * Products must be stored in dry, ventilated storages at the temperature not lower than -30°C.

10. Disposal

At the end of its service life the diffuser should be utilized in accordance with regulations and procedures, which are in force at the place of utilization.

For any further query please contact: - dr@drtrustusa.com