



**AIR COMPRESSOR NEBULIZER**  
**REFILLABLE RESERVOIR**

- Do not store the unit under direct sunlight, high temperatures or humidity.
- Keep the unit out of reach of small children.
- Always keep the unit engaged with the net to use.

**Cleaning Cautions:**

- Do not immerse the unit in water. It may damage the unit.
- Disconnect the unit from the electrical outlet before cleaning.
- Clean all necessary parts after each use as instructed in this guidebook.

**3. OPERATING YOUR COMPRESSOR NEBULIZER**

**Note:** Prior to initial operation, the nebulizer should be thoroughly cleaned.

1. Place your compressor nebulizer on a flat and stable surface. Be sure that you can safely reach the controls when you use the unit.

2. Open the clear cover and remove the inside accessories.

**Important:** Prior to initial operation, the nebulizer should be thoroughly cleaned referring to the "Cleaning Procedures" in the manual.

3. Assemble the nebulizer. Be sure the nebulizer is properly assembled to disassemble the nebulizer bottle.



- Fill the bottom section of the nebulizer bottle with the medication prescribed by your physician. Be sure that the cover is put in place to seal the bottle.
- Insert the top part of the nebulizer bottle into the nebulizer. Be sure the nebulizer is properly assembled to disassemble the nebulizer bottle.
- Attach the other end of the tube to the tube of the nebulizer bottle on the front of the compressor.
- Attach mouth piece or mask per your choice to the top section of nebulizer. Plug the power cord into an appropriate electrical outlet. Make sure all the plugs. The power switch is at "OFF" status.
- Press power switch to begin your prescribed treatment.

**Important:** The compressor motor has a thermal protector which will shut off the unit before the unit is overheated. When the thermal protector shuts the unit off, please:

- Switch off the unit.
- Unplug the cord from the electrical outlet.
- Wait 30 minutes for the motor to cool down before another treatment.

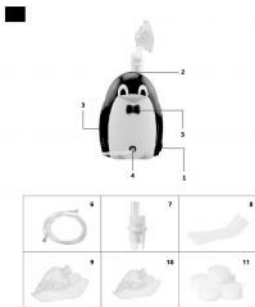

Make sure the air openings are not obstructed.

- When treatment is finished, shut off the unit and unplug it from the electrical outlet.

**4. CLEANING**

It is recommended that the nebulizer, mouthpiece and mask be thoroughly cleaned with hot water after each use and disassembled with a cloth changed after the last treatment of the day. If your physician or respiratory therapist specifies a different cleaning procedure, follow their instructions.

**Rinsing (after each treatment)**

- Disconnect the air tube, nebulizer, mouthpiece and mask.
- Clearly label the nebulizer to open it.
- Rinse the nebulizer, mouthpiece and mask with water.
- Dry with clean soft towel or let it air dry.
- Reassemble the nebulizer when completely dry and put these parts in a dry, sealed container.

**Disinfecting:**

Please follow the following steps to disinfect your nebulizer unless otherwise specified by your physician. It is suggested that the unit is disinfected after the last treatment of the day.

- Use one part white vinegar with three parts distilled water. Make sure correct solution is enough to submerge the nebulizer, mouthpiece and mask.
- Complete Rinsing Steps 1-3.
- Soak nebulizer, mouthpiece and mask in warm water and in mild detergent. Then wash them in hot tap water.
- Submerge these parts in the vinegar and water solution for thirty minutes.
- Complete Rinsing Steps 3-5.

**Cleaning the compressor**

- Wipe only with a damp cloth.
- Do not use any powdered cleaners or soap pads, which may damage the unit.

**Filter change**

- Do not use cotton or any other materials. Do not wash or clean the filter. Use only a filter. And do not operate without a filter.
- Change the filter every 30 days or when the filter turns gray.
- Changeing procedure:
  - Remove the filter cover.
  - Replace the filter cover.
  - Replace the used filter with a new one.

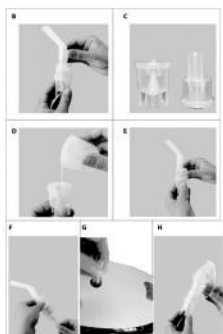

**1. COMPONENT**

- |                       |                      |
|-----------------------|----------------------|
| 1. Inlet/Out switch   | 7. Nebulizer bottle  |
| 2. Power              | 8. Mouthpiece        |
| 3. Air inlet openings | 9. Air tube          |
| 4. Filter             | 10. Pediatric mask   |
| 5. Air outlet         | 11. Spare air filter |
| 6. Air tube           |                      |

**2. IMPORTANT SAFEGUARDS**

**Note:** Read all instructions carefully before use.  
 The following basic precautions are needed when using an electrical product. Caution: Failure to read and observe all precautions could result in personal injury or equipment damage.

**Product cautions:**

- To avoid electrical shock: Keep the unit away from water. Do not immerse the power cord or the unit in liquid. Do not use while bathing. Do not touch the unit with wet hands. Do not use while showering. Do not use while swimming. Do not use while driving a vehicle.
- Never operate the unit if it has any damaged parts (including power cord). If it has been dropped or submerged in water, promptly send it to a service center for replacement or repair.
- The unit should not be used around flammable gas, oxygen or aerosol spray products, one being used.
- Disconnect the unit from the electrical outlet before cleaning, filling and after each use.
- Do not use other attachments unless recommended by manufacturer.

**Operating Cautions:**

- Connect the product to an appropriate voltage outlet for your model.
- Do not run the product unattended.
- Never operate if the unit has a damaged cord or plug, if it has been dropped, or in any way into water. If it does not work properly, return it to a service center for repair.
- If any abnormality occurs, discontinue use immediately until the unit has been examined and repaired.
- Always unplug the product immediately after use.
- Never stick the air opening of the mask into a place where the air openings may be obstructed.

**Storage Cautions:**

**C. Replace the filter cover**

**5. REPLACEMENT PARTS & OPTIONAL ACCESSORIES**



Replacement parts are available through your local distributor or they can be ordered by mail.  
 Optional accessories include adult mask and baby pacifier straps. The pacifier strap allows baby to receive aerosol treatment easily through nipple shield.

**6. SPECIFICATIONS**

Power	AC 220V, 60Hz
Power Consumption	100 VA Max.
Medication Capacity	10ml
Particle Size	2.5 to 10 µm
Mask	1.5ml
Sound Level	Around 55 dBA
Average Nebulization Rate	0.2 ml/min (2% saline solution)
Compressor Pressure Range	28 to 52 Pa (200 to 380 NCM / 12 to 3.5 bar)
Operating Pressure Range	1.6 to 19 Pa (0.01 to 138 NCM / 0.04 to 1.3 bar)
Low Flow Range	0.1 to 0.5 lpm
Operating Temperature Range	5°C to 30°C (41°F to 86°F)
Storage Temperature Range	10 to 30°C (50 to 86°F)
Storage Humidity Range	10 to 85 % RH
Dimensions (L x W x H)	170x 100 x 240mm
Weight	1.5kg / 3.3kg
Standard Accessories	Nebulizer bottle, Air tube, Mouth piece, Filter/cover, Adult mask, Child Mask
Optional Accessories	Baby pacifier attachment, Nose piece

For any query contact: dr@drtrust.com